

PLAN 1:100

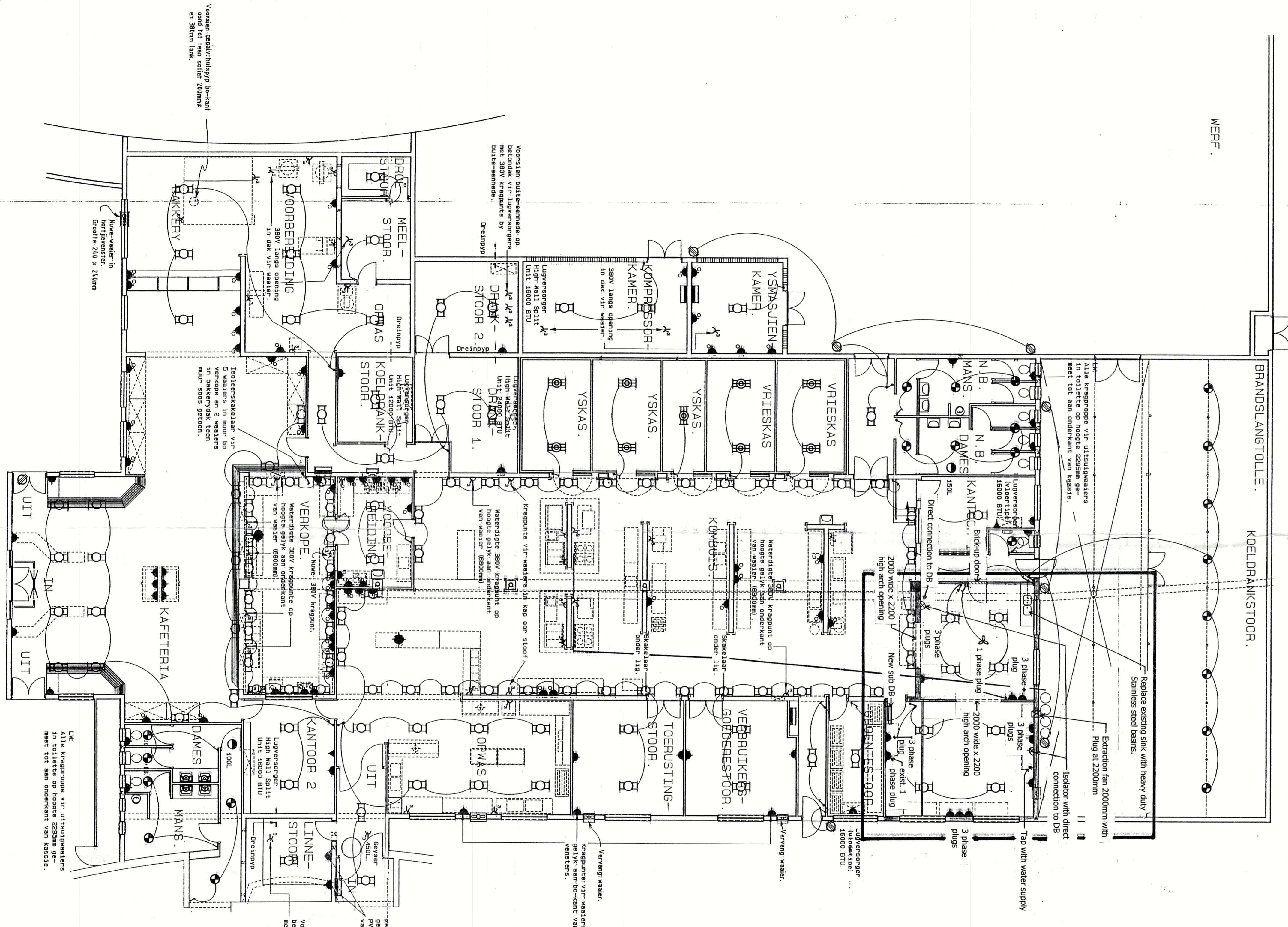

- NOTES:**
1. Close up existing door.
  2. Break in tow openings of 2000 wide x 2200 high from ffl.
  3. All 3 phase connections to be isolators and pipes at 1300mm and 300mm respectively.
  4. Isolator and 3 phase breakers next to new extractor fan, to be at 2300 high (oven height = 2200)

ELECTRICAL LEGEND	
SYMBOL	DESCRIPTION
[Symbol]	DISTRIBUTION BOARD RECESSED IN WALL
[Symbol]	ELECTRICAL GEYSER WITH 2 POLE ISOLATOR 1000 mm ABOVE GEYSER.
[Symbol]	KWIKOT GEYSER (1511t/2511t/3011t) WALL MOUNTED WITH ELECT. PLUG POINT OR GAS FUNCTION AS DETERMINED BY ENG.
[Symbol]	15 Amp WALL PLUG (new) 300 mm ABOVE F.F.L. TO U/S CASEMENT.
[Symbol]	UNDERSIDE OF WALLPLUG COVERPLATE FOR AIR CONDITIONING UNIT TO BE THE SAME AS THE UNDERSIDE OF THE A/C UNIT AND 115 mm RIGHT OF THE A/C UNIT
[Symbol]	15 Amp WALL PLUG (new) 1300 mm ABOVE F.F.L. MEASURED TO UNDERSIDE OF COVERPLATE.
[Symbol]	15 Amp WALL PLUG (new) 1100 mm ABOVE F.F.L. MEASURED TO UNDERSIDE OF COVERPLATE.
[Symbol]	15 Amp WALL PLUG (new) 900 mm ABOVE F.F.L. MEASURED TO UNDERSIDE OF COVERPLATE.
[Symbol]	ISOLATOR SWITCH
[Symbol]	STOVE SWITCH
[Symbol]	WALL PLUS 380 V AT HEIGHT AS INDICATED ON PLAN.
[Symbol]	TWO POLE ISOLATOR.
[Symbol]	WALL LIGHT AT 2200 mm TO MIDDLE OF CASEMENT.
[Symbol]	OUTSIDE LIGHT AT 2200 mm ABOVE F.F.L.
[Symbol]	CEILING MOUNTED LIGHT
[Symbol]	DOUBLE TUBE FLOURESCENT
[Symbol]	READING LIGHT AT 1550 AFFL
[Symbol]	CHEESECAKE LIGHT FITTING WALL MOUNTED AT 2200 AFFL
[Symbol]	DOUBLE SPOTLIGHT AT 2500 AFFL
[Symbol]	SINGLE LIGHT SWITCH 1300 mm ABOVE F.F.L.
[Symbol]	SINGLE LIGHT SWITCH, 1100mm AFFL FOR READING LAMP ON CENTER LINE OF LIGHT FITTING OVER
[Symbol]	DOUBLE LIGHT SWITCH 1300 mm ABOVE F.F.L.
[Symbol]	THREE PHASE LIGHT SWITCH 1300 mm ABOVE F.F.L.
[Symbol]	TWO WAY LIGHT SWITCH 1300 mm ABOVE F.F.L.
[Symbol]	SWITCH FOR CEILING FAN AT 1300 mm ABOVE F.F.L.
[Symbol]	TELEPHONE POINT NEAREST TO INSTALLATION POINT.
[Symbol]	T.V. ANTENNA INSTALLATION POINT AT 300 mm ABOVE F.F.L.
[Symbol]	TOP OF AIR CONDITIONER LEVEL WITH TOP OF WINDOW.
[Symbol]	CEILING FAN ELECTRICAL POINT. FAN AT 2500 AFFL

USE DIMENSIONS ON PLAN BEFORE MEASURING OFF DRAWINGS.

notes :

DIRECTOR: KNP

SIGNED \_\_\_\_\_ DATED \_\_\_\_\_

GEN. MANAGER: TECHNICAL SERVICES

SIGNED \_\_\_\_\_ DATED \_\_\_\_\_

CLIENT: \_\_\_\_\_

SIGNED \_\_\_\_\_ DATED \_\_\_\_\_

REVISIONS :

No.	DATE	DRWN	DESCRIPTION

**SAN PARKS**
  
 TECHNICAL SERVICES DEPARTMENT

**KRUGER NATIONAL PARK**

project: **SKUKUZA ALTERATIONS TO EXISTING RESTAURANT**

drawing: **WORKING DRAWING**

drawn CO	drawn no. SKZ1F200	rev
date 00/07/04	checked elec.	date
scale 1:100	checked tech.	date
file no. F083/00	I.K. No.	17/14/