

S.G. No.

102 / 2013

Approved

for  
SURVEYOR-  
GENERAL

2013-04-11

THIS DIAGRAM CONSISTS OF 5 SHEETS

Sheet 1

STATE LAND

The figure

A, middle of Mutale River, B, middle of Luvuvhu River, C, D,  
E, F, G, H, J, K, L, M, N, P, Q, R, middle of Olifant River,  
S, T, U, V, U, X, Y, Z, middle of Little Letaba River, A1, B1,  
C1, D1, E1, F1, G1, H1, J1, K1, middle of Luvuvhu River, L1, A

represents

963 528,784 hectares

of land being

the farm

KRUGER NATIONAL PARK NORTH No. 449 - MT

Province of Limpopo

Framed in terms of Section 16 of Act 8 of 1997,  
in March 2013 by me

  
D.S. Pound  
Professional Land Surveyor  
Registration Number PLS 0491

This diagram is annexed to No. d.d. : i.f.o. Registrar of Deeds PRETORIA	This is the original diagram S.G. No. : Transfer Grant :	File : MT - 449 S.R. : Framed Comp. : MUSA, MUNV, MUNW, MUSB, MUSG, MUSM, MUNN, MUSS, MUSO, MUSX, LUNC, LUNH, LUNN
---	---	---

The farm KRUGER NATIONAL PARK NORTH No. 449-MT

S.G. No.  
102 / 2013

Sheet 2 of 3 Sheets

Approved



for  
SURVEYOR-  
GENERAL

2013-04-11

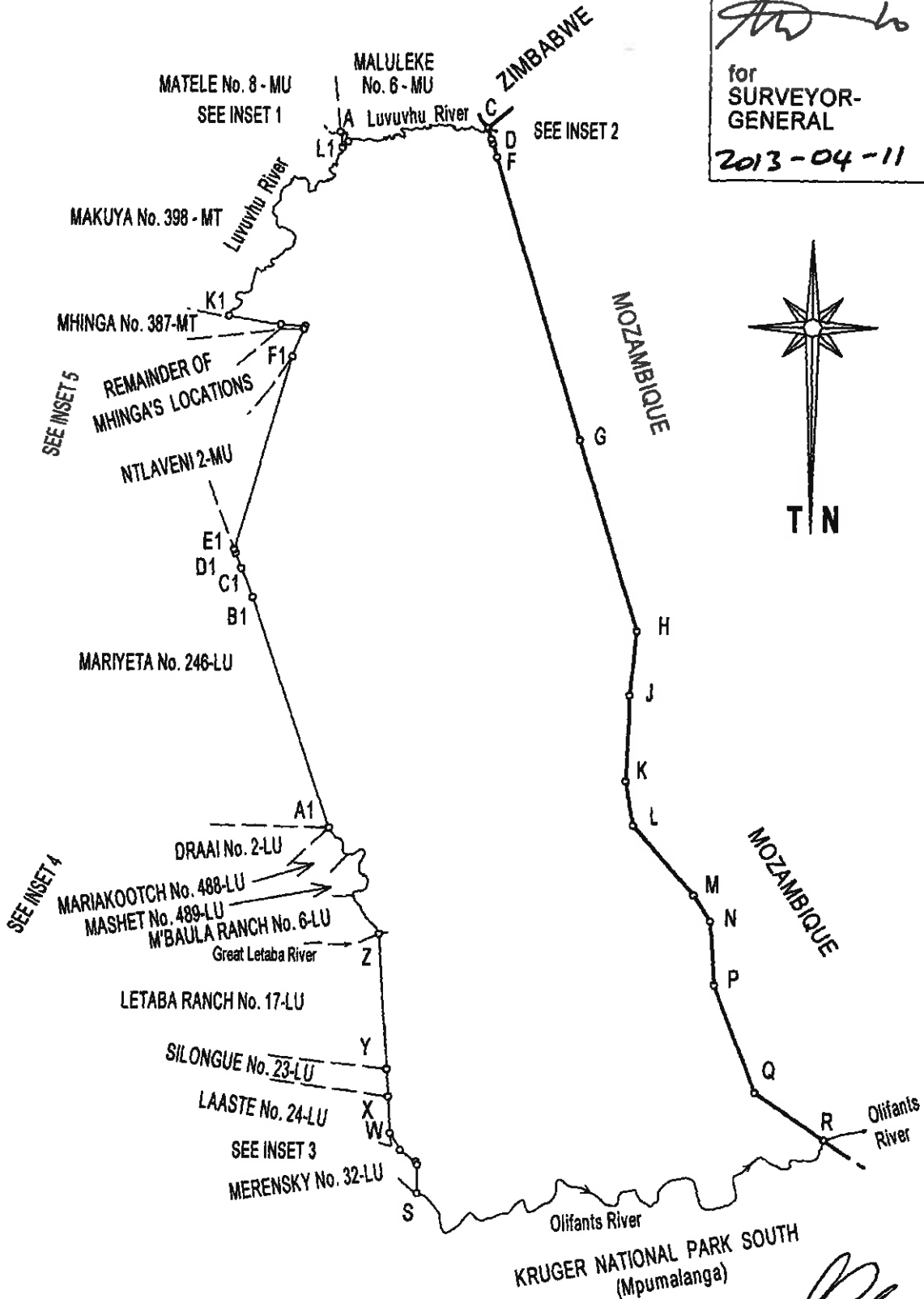

Province of Limpopo  
Framed in terms of Section 16 of Act 8 of 1997,  
in March 2013 by me

D.S. Pound  
Professional Land Surveyor  
Registration Number PLS 0491



The farm KRUGER NATIONAL PARK NORTH No. 449 - MT

S.G. No.

INSET 1 - NOT TO SCALE

102 / 2013

MATELE No. 8 - MU

Approved

for  
SURVEYOR -  
GENERAL

2013-04-11

MAKUYA No. 398 - MT

Sheet 3 of 5 sheets

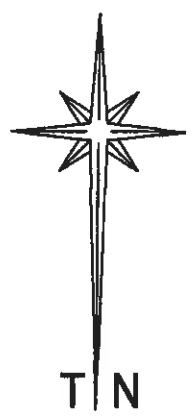
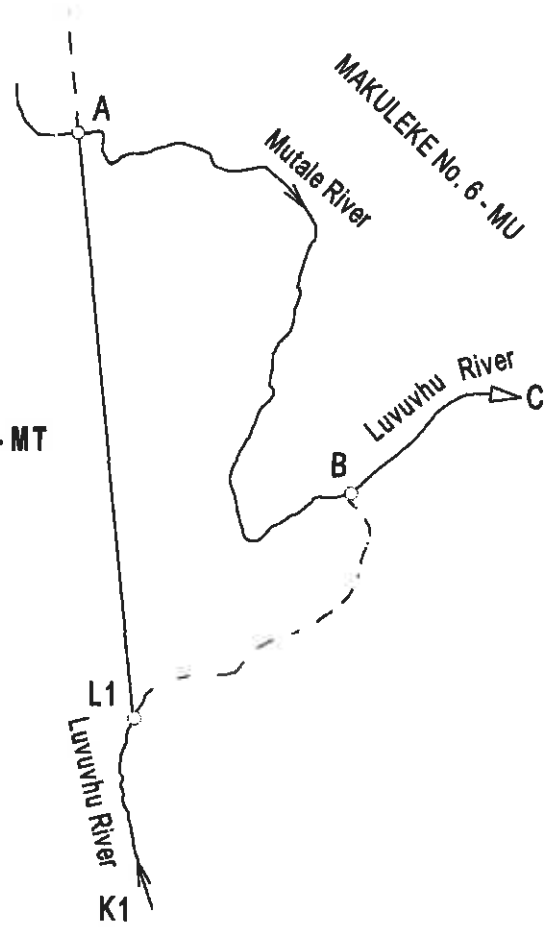

INSET 2 - NOT TO SCALE

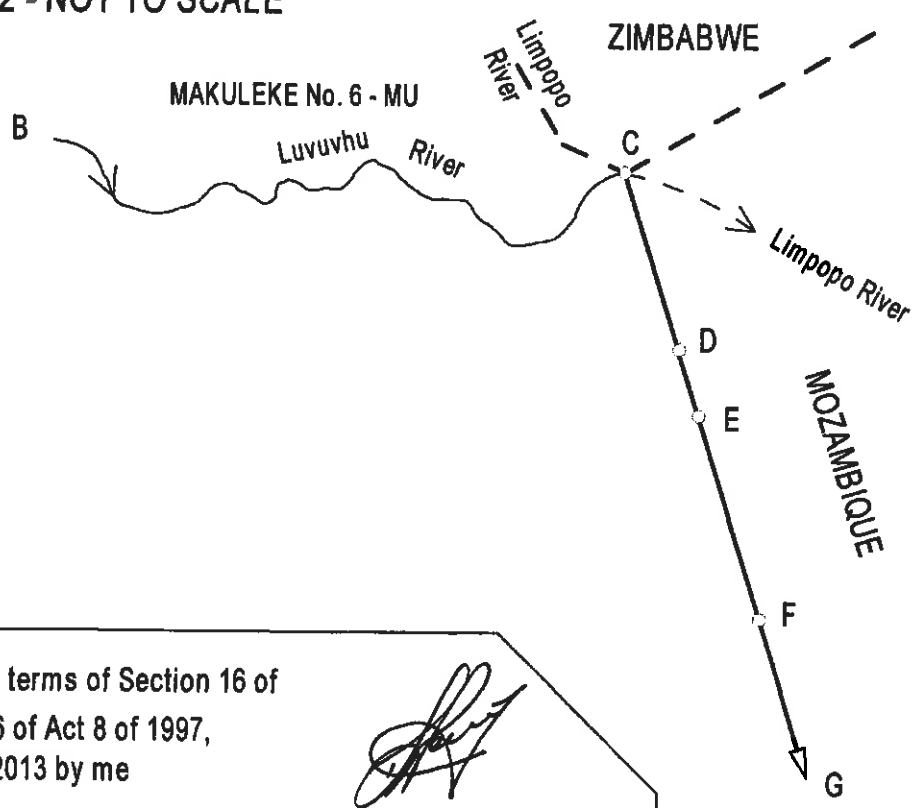

Framed in terms of Section 16 of  
Section 16 of Act 8 of 1997,  
in March 2013 by me

D.S. Pound  
Professional Land Surveyor  
Registration Number PLS 0491

The farm KRUGER NATIONAL PARK NORTH No. 449 - MT

S.G. No.  
102 / 2013

Approved



for  
SURVEYOR -  
GENERAL  
2013-04-11

INSET 3 - NOT TO SCALE

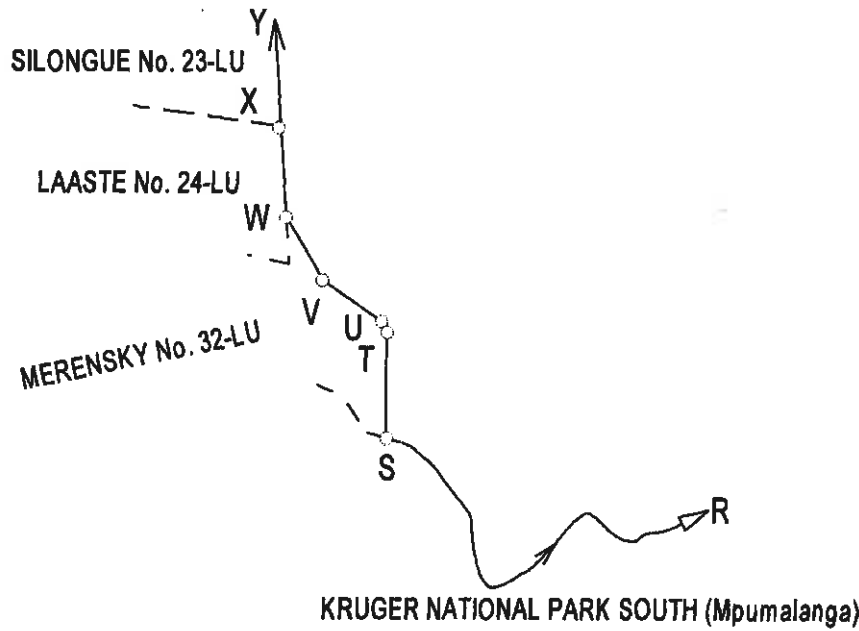

Sheet 4 of 5 sheets

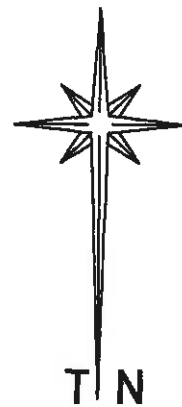

INSET 4 - NOT TO SCALE

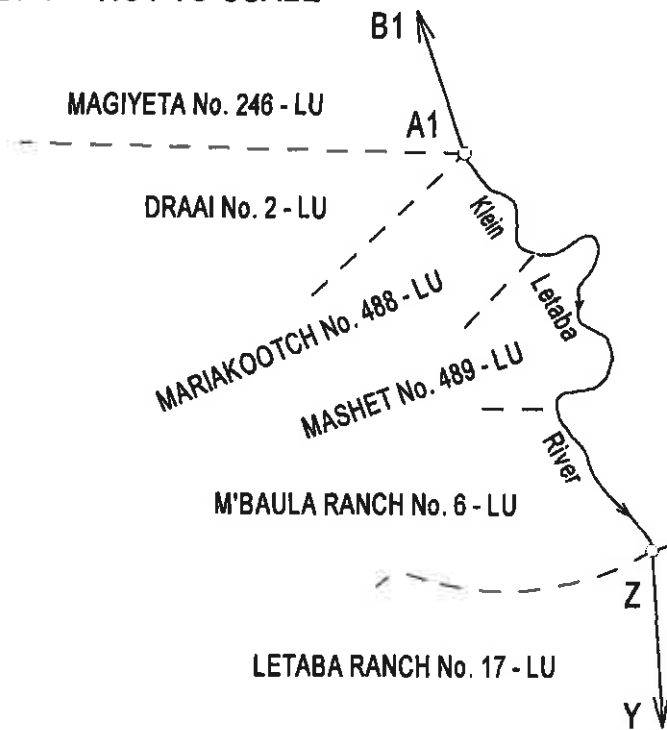

Framed in terms of Section 16 of  
Section 16 of Act 8 of 1997,  
in March 2013 by me



D.S. Pound  
Professional Land Surveyor  
Registration Number PLS 0491

The farm KRUGER NATIONAL PARK NORTH No. 449 - MT

S.G. No.

102 / 2013

Approved



for  
SURVEYOR -  
GENERAL

2013-04-11

INSET 5 - NOT TO SCALE

Sheet 5 of 5 sheets

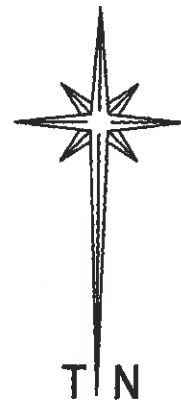
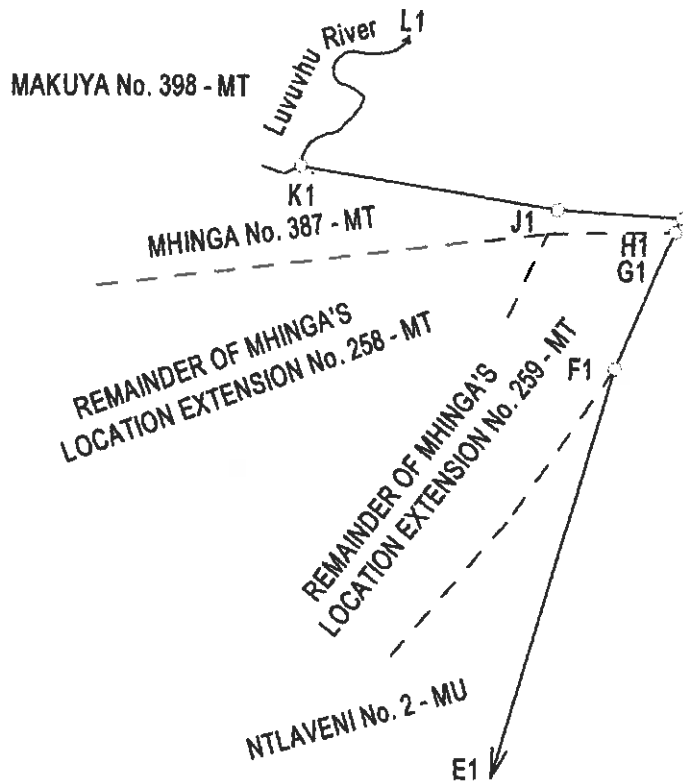

Framed in terms of Section 16 of  
Section 16 of Act 8 of 1997,  
in March 2013 by me



D.S. Pound  
Professional Land Surveyor  
Registration Number PLS 0491