



**South African
NATIONAL PARKS**

KIOSK & CURIO SHOP



OPPORTUNITY

To operate, for commercial purposes, a Kiosk & Curio Shop for 8 years.

A single operator for both facilities is required.

REQUIREMENTS

- **Provide Kiosk Food and Beverage:** quality and value-add on-the-go food and beverages (coffee, cappuccino, café latte, and hot chocolate) plus cool drinks, healthy sorbets and ice cream inclusive.
- **Provide Retail Curio:** must provide Dinosaur (IC) related products - mostly artistic and cultural items/souvenirs - **NB: NO FOOD OR BEVERAGE ITEMS BE SOLD AT THE RETAIL CURIO FACILITY.**

IDENTITY OF BIDDERS

- Single company / unincorporated JV / Trust.
- One SPV to contract with SANParks.
- Bid to provide detail of SPV structure and roles & responsibilities.
- 5% free equity to Land Claimants Trust (nominated by SANParks Social Economic Transformation Department).

QUALIFICATION CRITERIA

Financial Capacity:

- Minimum business turnover not less than R100 000.00 per annum but not exceeding R2.5 million.

FINANCIAL REQUIREMENTS

- Audited or independently reviewed financial statements corresponding to the last 2 years, or
- Statements of assets, with confirmation of ownership, certified by a qualified auditor.

TOURISM EXPERIENCE

- 2 years proven operating experience in the tourism industry.
- At least 1 existing operational facility in existence). Technical partner meeting these requirements must hold at least 30% shares in SPV.

B-BBEE - (EME TARGETED)

- Bidder must be minimum Level Three Contributor or above.
- Bidder to complete B-BBEE Proposal requirements – anticipated SPV's annual revenue will qualify as EME; however, operator to resubmit undertakings upon reaching QSE status.

SITE – LOCATION

- Located in the primitive zone, opposite Glen Reenen along the R712 provincial road.

DINOSAUR CENTRE LAYOUT

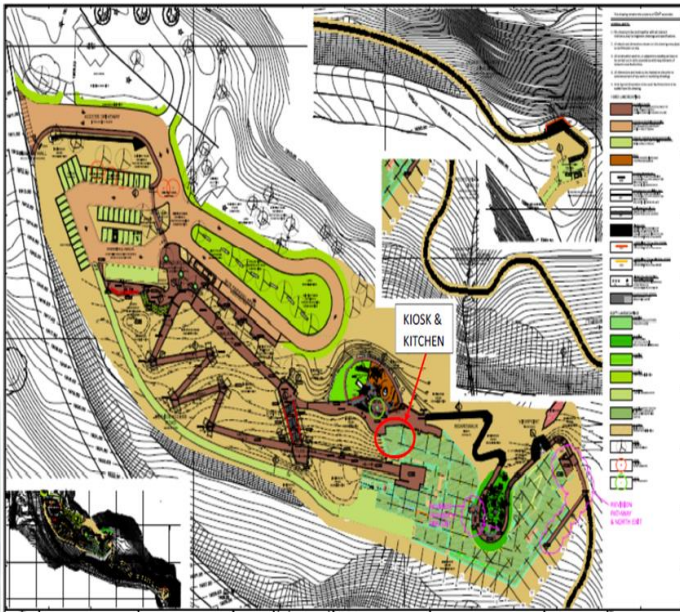

SIZE OF THE FACILITIES

Description of the Shop Area	Measurements (m ²)
Retail- Curio-Shop	21
Food-Kiosk and-serving-counter	46
Kitchen and-Storage	37
Total	104

ACCESS ROAD

- Accessible via the R712 provincial road.

ELECTRICITY

- SANParks to provide electricity point with a meter to measure billed in line with SANParks Tariff policy.

TELECOMMUNICATIONS

- Operator responsible for arranging communication infrastructure for the operation of the facility.

WATER

- SANParks to provide electricity point with a meter to measure billed in line with SANParks Tariff policy.

WASTE

- Solid waste must be separated onsite into recyclable and non-recyclable waste, and stored safely before disposal at an authorised Park's waste facilities.
- The Operator will be required to provide a plan for waste disposal, in accordance with Environmental Guidelines for Operator's Operation within The South African National Parks, provided in Annexure 1 of the Info Memo

NB: Detailed site and layout information in page 21.22 & 23 of 94 of the Information Memorandum

ENVIRONMENTAL CONSIDERATIONS

- Refer to info memo page 38 of 94 and RFP 32 of 48

NB: No EIA required for the activity

STAFF AND HOUSING

- No Staff housing is available.

BID BOND

- Amount: R 24 000.

PPP FEE PAYABLE

- Higher of:
 - (1) Minimum PPP Fee of R2 000 per month (excl. VAT), or
 - (2) <bidded>% of Gross Revenue.

EVALUATION

Two-envelope system:

- One: Functionality (including B-BBEE Proposal) – 65% overall threshold.
- Two: PPP offer and existing B-BBEE rating (80/20 system)

TERMS AND CONDITIONS

The above information is a summary of the opportunity. Please note that the Request for Proposal (RFP) and Information Memorandum documents are published on the SANParks Web Site (www.sanparks.org) and contains more detail on the opportunities and supersede this document.