

Site visit document

Spa opportunities

Bid Package 1: Berg en Dal and Pretoriuskop.

Bid Package 2: Satara, Orpen, Tamboti and Talamati.

Bid Package 3: Letaba, Olifants, Balule, Tsendze, Mopani and Shimuwini.

Bid Package 4: Punda Maria, Pafuri Border, Shingwedzi, Bateleur and Sirheni.

** Only main camps (underlined were shown as part of the site visits). Other camps also part of opportunity but could be taken back if product is not offered there

TERM

10 years

OPPORTUNITY/IES

Present a Spa product in SANParks' main camps and/or smaller camps and/or bushveld camps as defined in the Packages.

Build or erect the Spa (permanent structure) in one of the main camps in the Bid Package. Build staff housing in the main camp to serve as base.

Note: *Except for BP1 as the camps are both on the periphery of the park and hence staff will be discouraged to stay inside due to social issues associated with this.*



Present a Spa product in SANParks' main camps and/or smaller camps and/or bushveld camps as defined in the Packages.

Mobile component i.e. motorhome and/or trailer and/or tent structure (including small bedouin tent) for use in other camps.

Area allocated approximately 100m² with dedicated water and electricity point.

As an example to be developed - small greeting area and a treatment room - option to add a splash pool / sauna area / steam room / hot tub in camps where permanent structure is build.

QUALIFICATION CRITERIA

Experience:

Number of functional outlets:

At least one (1) functional outlet of the spa brand proposed and brand proposed and should have included a mobile aspect. i.e. setup away from physical buildings (events will qualify).

Existence

The brand proposed should have been operational for at least one (1) year.

Turnover of the outlet

Combined turnover of the outlets in operation proposed should not be less than R 200,000 per annum.

BEE status

The bidder must be an EME or QSE with black women ownership of at least 75%.

ADDITIONAL DEVELOPMENT SPECIFICATIONS:

Cooling: At least a fan but preferably a small air conditioner – one air conditioner per camp allowed.

Food: Limited catering in line with the product allowed, i.e. cold lemonade or water with berries, snacks such as nuts, biltong, etc.

Décor: The décor should be funky and attract people to the spa. However, this should not be distracting and aim to fit into National Parks. Colors such as pink will be allowed but should be done tastefully.

Gym: Small gym in line with product will be allowed (but within footprint).

Pool: A small splash pool will be allowed if required but should not be in the view of the general public.

Sauna / steam room / hot tub: These items might be allowed if it fits into the development area.

Music: Soothing background music might complement the product or the operator might decide to stick with the sound of nature.

Toilets: The guests will primarily be required to make use of communal ablution facilities and not facilities at the site. A small toilet facility might be allowed if design fits into the allocated area.

Plans: Approval of plans by SANParks technical services and conservation services.

Development period: The operator needs to obtain all approvals and build the spa facility within 12 months from signature date of the PPP Agreement.



ECO audits

ECO audits to be conducted by the Private Party at own cost twice a year – examples to outline this requirement.

PPP Agreement and updated documents:

PPP Agreements and updated documents will be distributed to all bidders following the bidders conference and conclusion of Q&A's.

Staff

Private Party to appoint staff.

Staff housing only allowed to be built in main camps (if space is available for this and subject to SANParks' approval).

Staff Housing

No housing rent payable -> Building cost and maintenance cost for the bidder' account.

Straight-line depreciation with residual value payable at end of contract period

PPP Fee

PPP fee payable - higher of the (1) Minimum Rental of R 1,000 (excl. VAT per month) or (2) <Bidded> ____ % of Turnover.



IMPORTANT TO NOTE:

Bidders Conference: A bidders conference will be held on 30 November 2020 from 14h00 to 16h00. Please register for the bidders conference by sending your e-mail address to james.Daniels@sanparks.org by close of business on 25 November 2020.

Bid Package 1

Main camps to follow.



South African
NATIONAL PARKS

BERG-EN-DAL

Emergencies
For medical or other
emergencies call
082 802 1201



Berg en Dal

Spa site:
X1: site 1

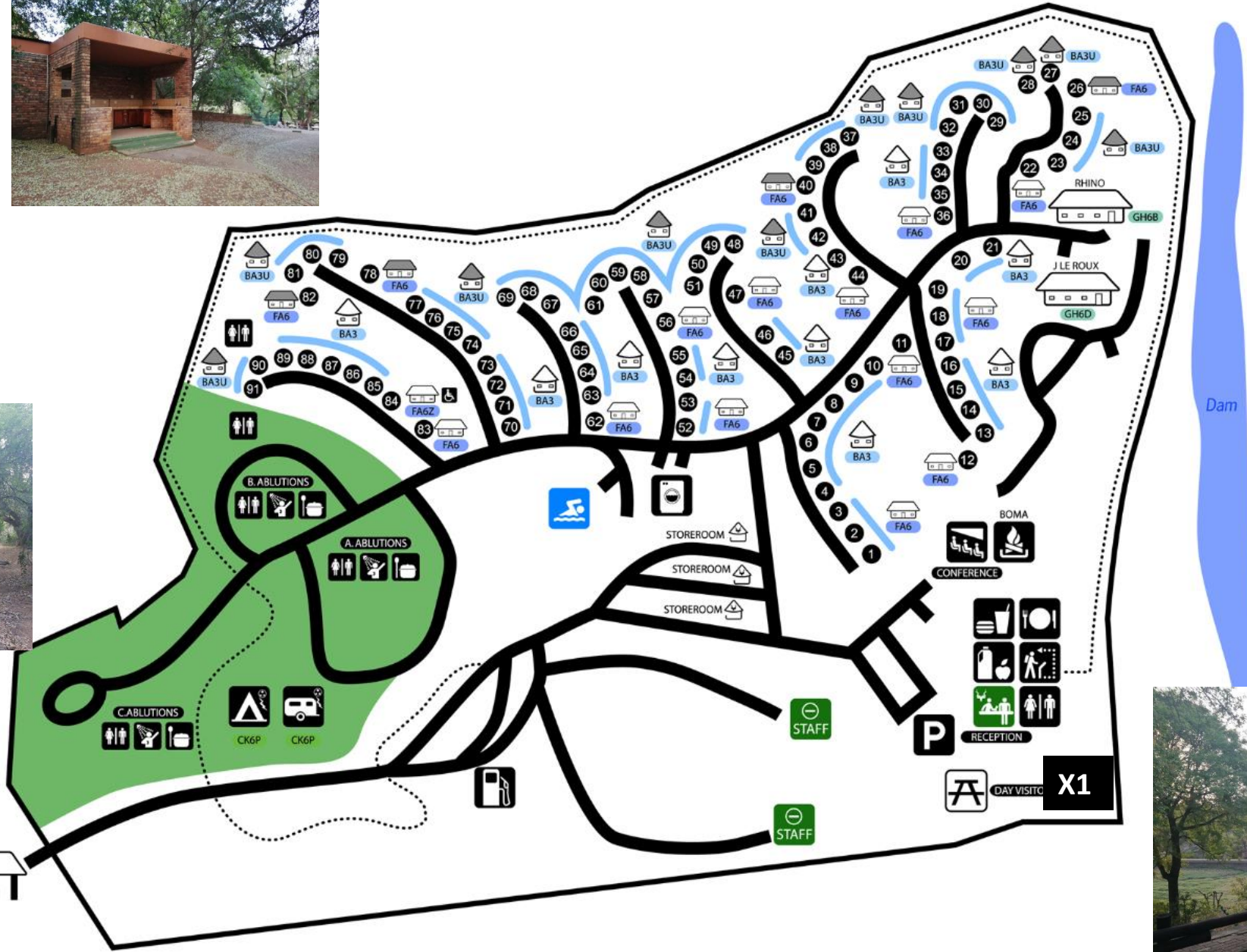

Dam







South African NATIONAL PARKS

PRETORIUSKOP

Emergencies
For medical or other
emergencies call
082 802 1203

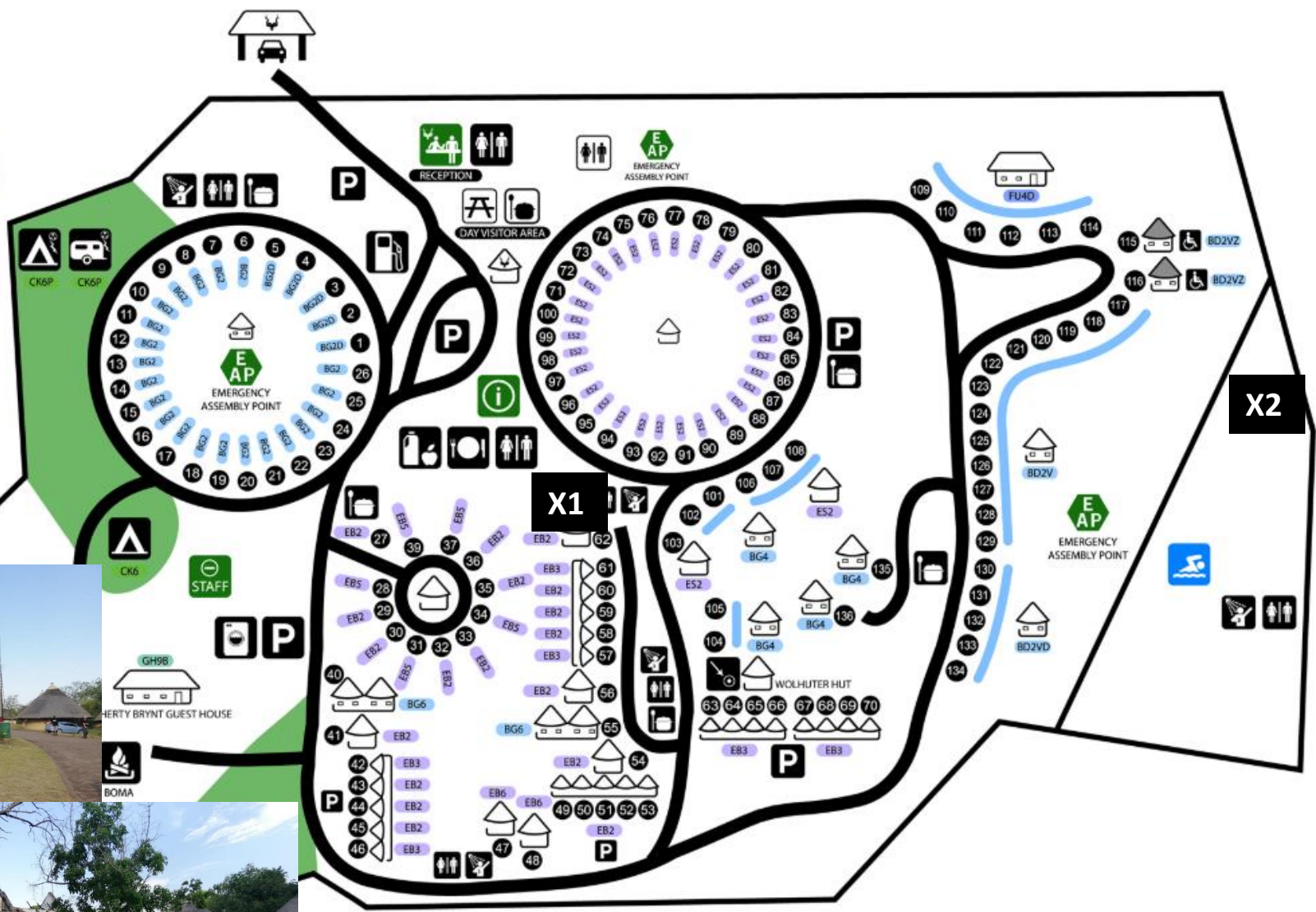

Pretoriuskop

Spa sites:
X1: site 1
X2: site 2



X2

X1

X1



X2



Bid Package 2

Main camps to follow.

Together with Orpen, Tamboti and
Talamati

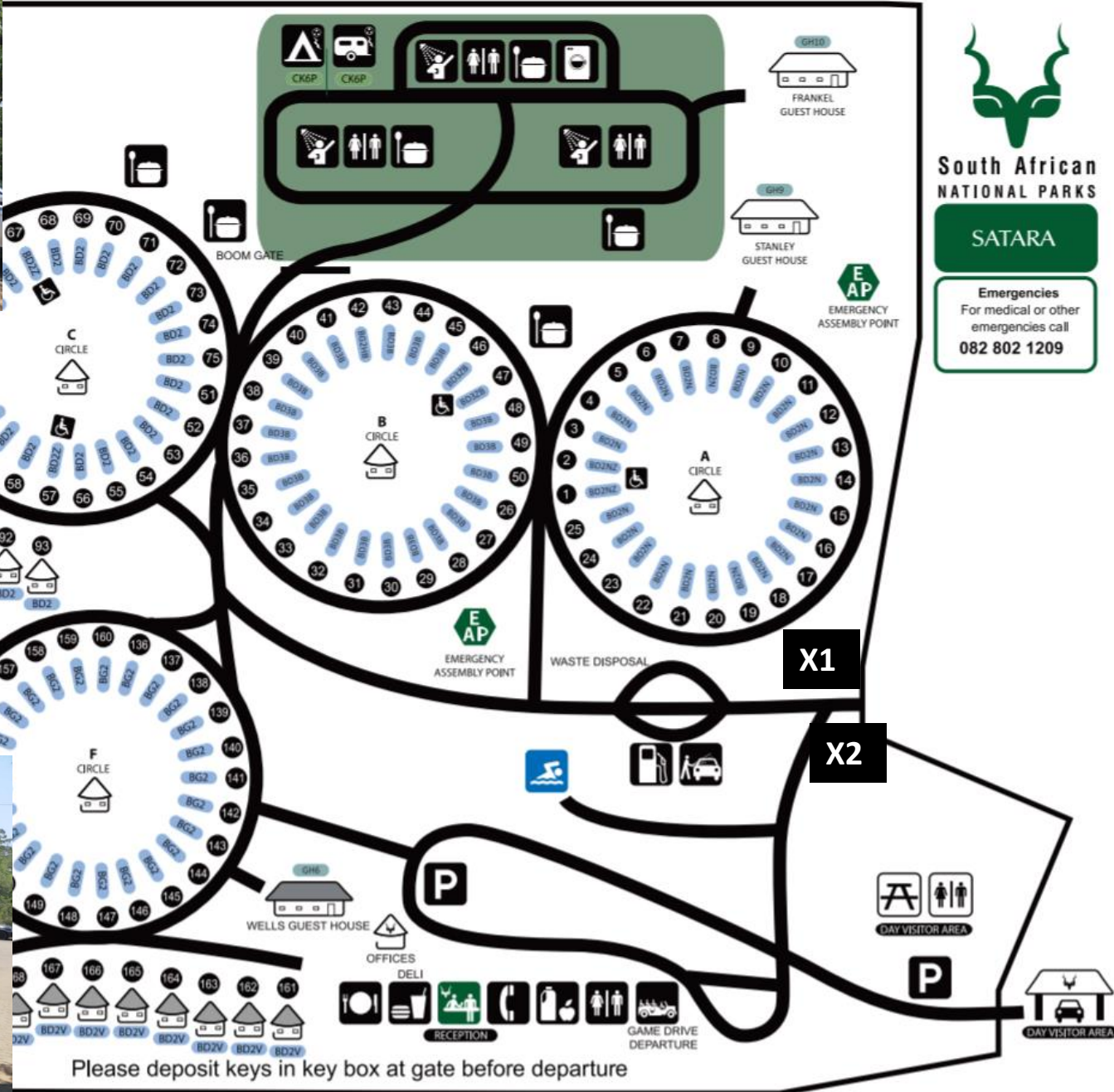

South African NATIONAL PARKS

SATARA

Emergencies
For medical or other emergencies call
082 802 1209

SATARA

Spa sites:
X1: site 1
X2: site 2





Bid Package 3

Main camps to follow.

Together with Balule, Tsendze
and Shimuwini



South African NATIONAL PARKS

OLIFANTS

Emergencies
For medical or other emergencies call
082 888 6563

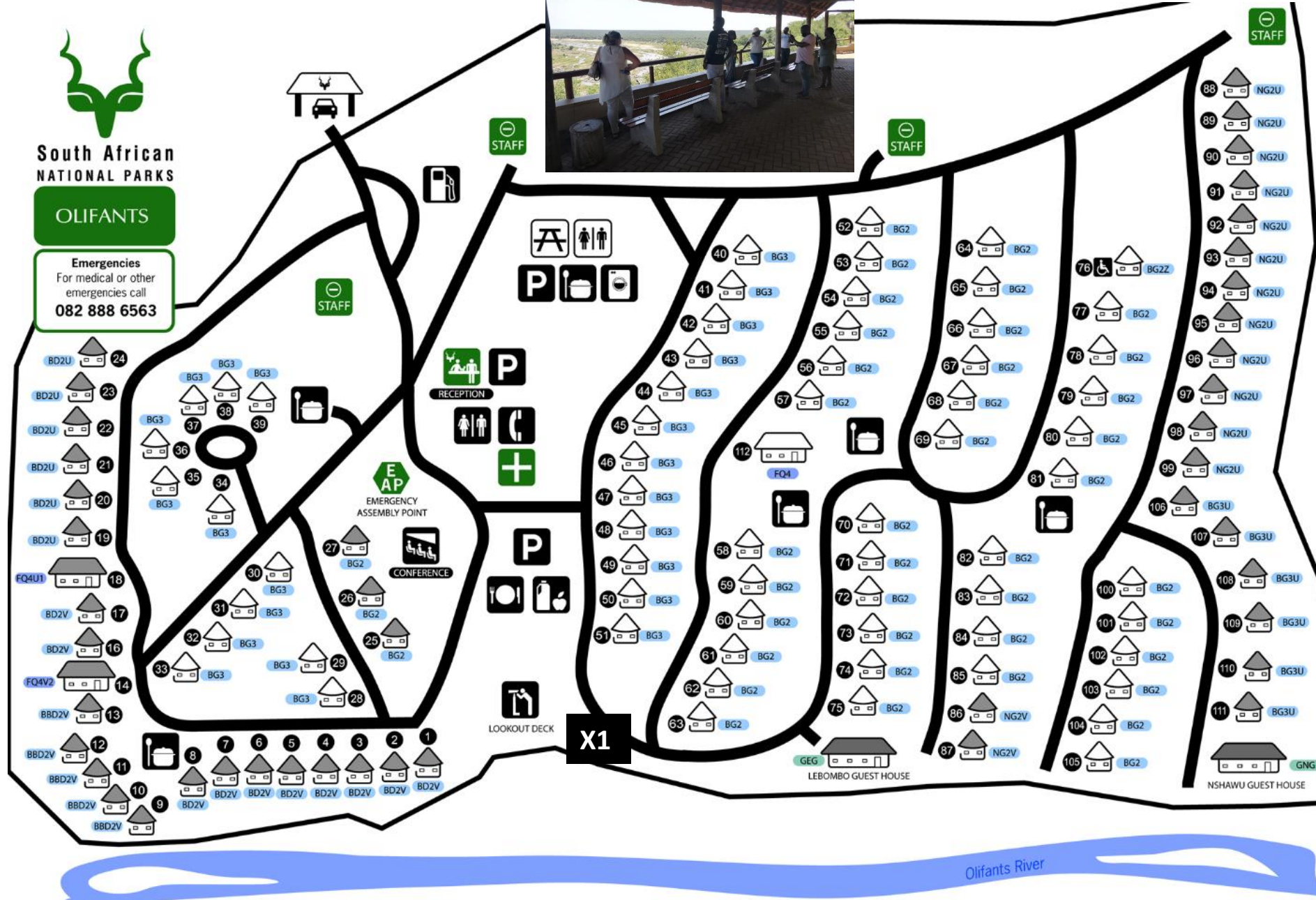

Olifants

Spa site:
X1: site 1



LETABA

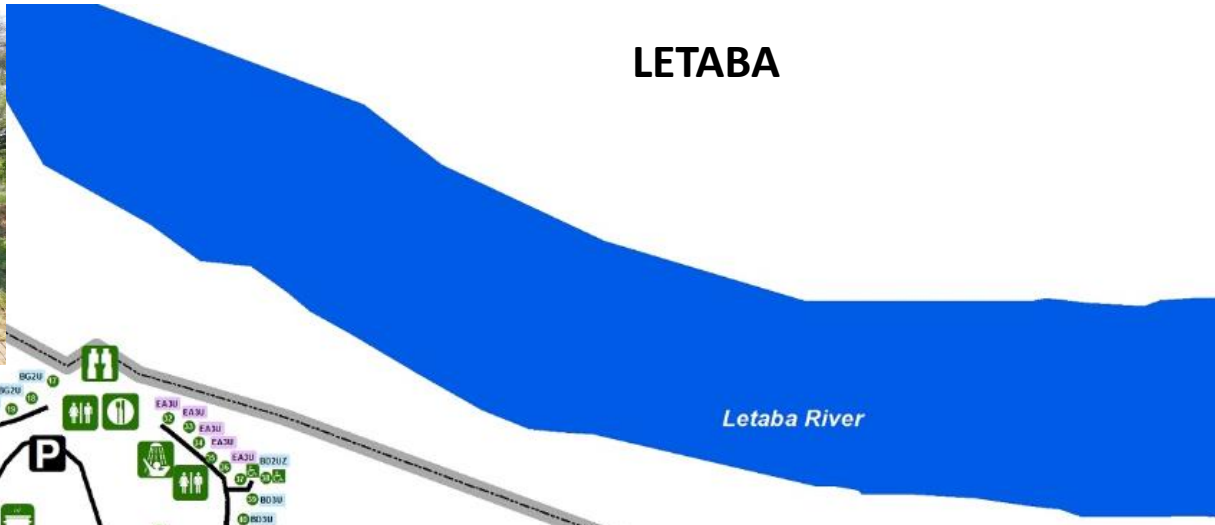

Letaba River



X2

X1



South African NATIONAL PARKS

LETABA

Emergencies
For medical or other emergencies call
082 802 1255



Please deposit keys in key box at the gate before departure

Spa sites:
X1: site 1
X2: site 2



X1



X2



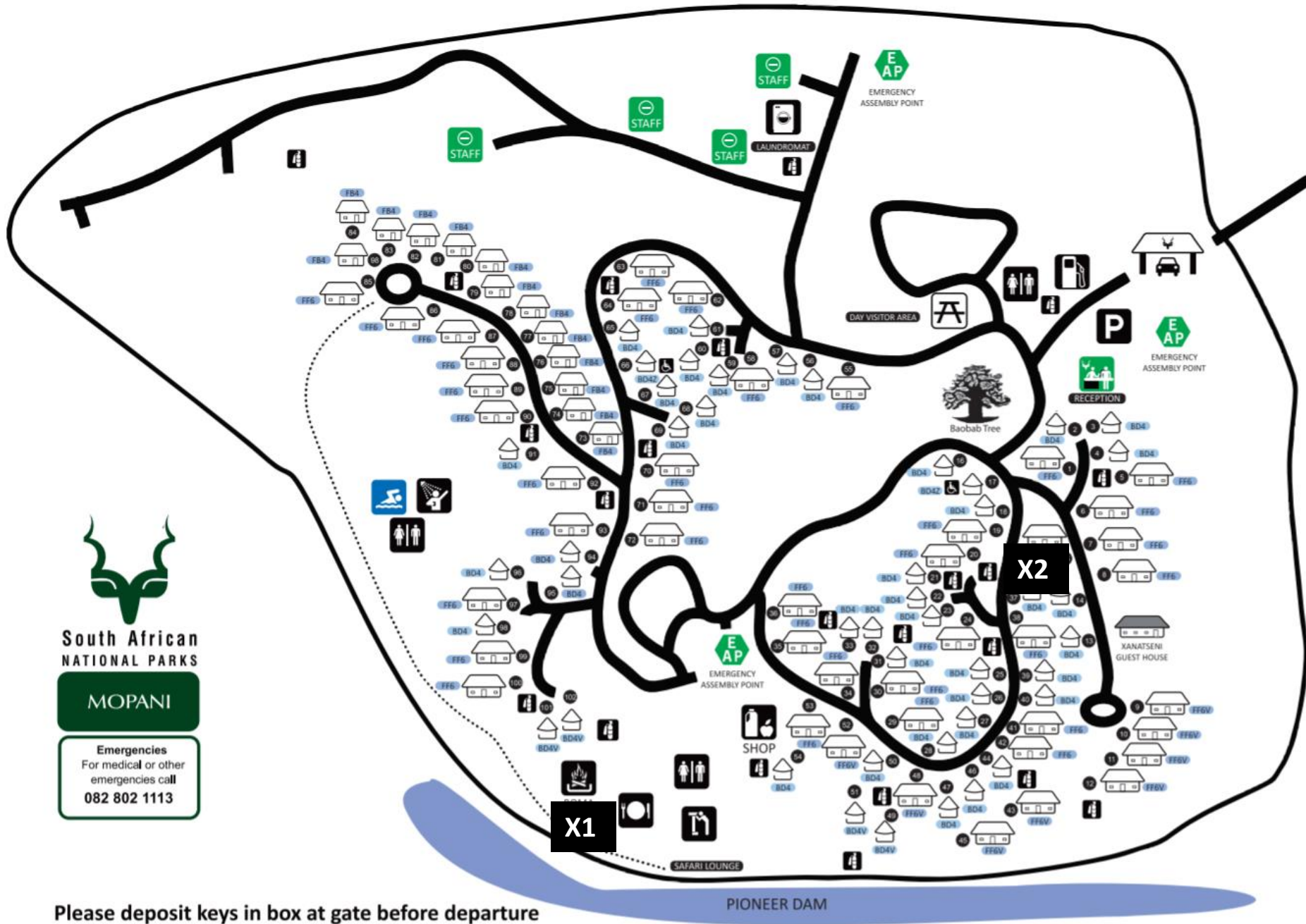

South African NATIONAL PARKS

MOPANI

Emergencies
For medical or other emergencies call
082 802 1113

MOPANI

Spa sites:
X1: site 1
X2: site 2

Please deposit keys in box at gate before departure

PIONEER DAM

X1



X2



Bid Package 4

Main camps to follow.

Together with Pafuri Border,
Bateleur and Sirheni.



South African
NATIONAL PARKS

SHINGWEDZI

Emergencies
For medical or other
emergencies call
082 889 4376



Shingwedzi

Spa site:
X1: site 1



Please deposit keys in key box at the gate before departure





South African NATIONAL PARKS

PUNDA MARIA

Emergencies

For medical or other emergencies call **082 802 0066**

Punda Maria

**Mobile Spa site:
X1: site 1**

