

**SITE RETICULATION:
WATER SERVICES**

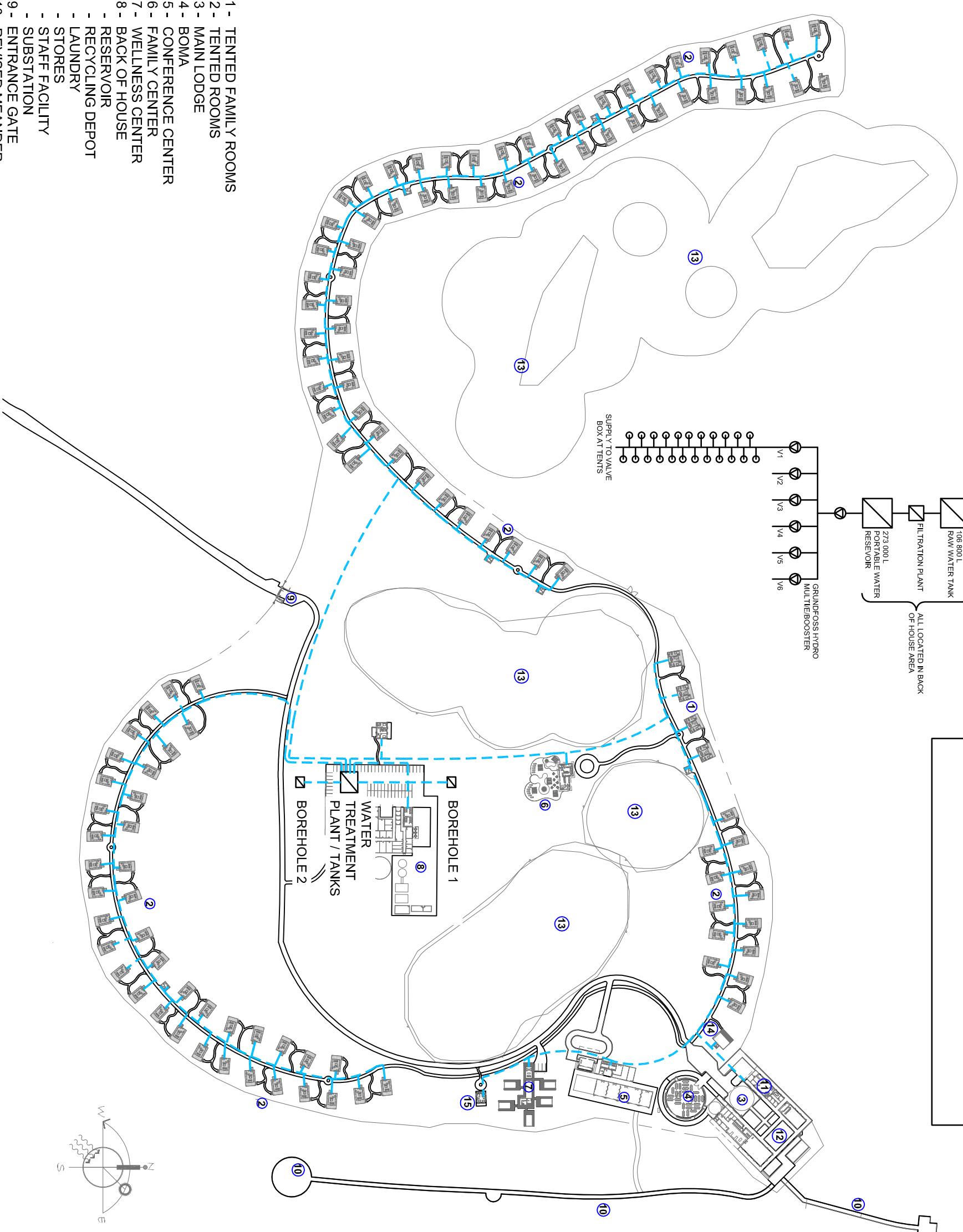

- 1 - TENTED FAMILY ROOMS
- 2 - TENTED ROOMS
- 3 - MAIN LODGE
- 4 - BOMA
- 5 - CONFERENCE CENTER
- 6 - FAMILY CENTER
- 7 - WELLNESS CENTER
- 8 - BACK OF HOUSE
- RESERVOIR
- RECYCLING DEPOT
- LAUNDRY
- STORES
- STAFF FACILITY
- SUBSTATION
- 9 - ENTRANCE GATE
- 10 - REVISED MEANDER
- 11 - OFFICES
- 12 - COVERED ENTRANCE DECK
- 13 - PROTECTED PLANT SPECIES
- 14 - EDUCATION CENTER
- 15 - GYM

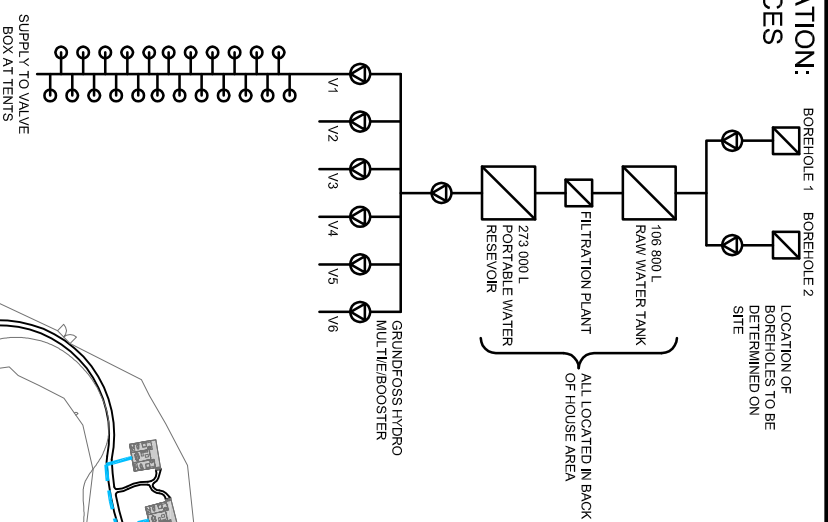
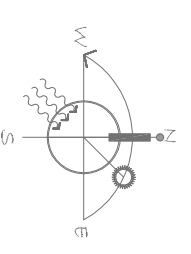

PROJECT DRAWING NO.	285-SK02-A100	REVISION	18
---------------------	---------------	----------	----

REVISION RECORD	
Date	DESCRIPTION
08/02/15	PRELIMINARY DESIGN FOR INFORMATION PURPOSES ONLY
D.N.	

client
KRUGER NATIONAL PARK

project
MALELANE SAFARI LODGE

description
SITE PLAN
MAIN WATER RETICULATION
SCHEMATIC

CONSULTING ELECTRICAL ENGINEERS (Pty) Ltd

28 Thora Crescent
Wynberg
Sandton
PO Box 808
Cromerview, 2060
South Africa
Tel: (011) 262 6078
Fax: (011) 262 6135
e-mail: info@watnata.co.za

drawn	design	approved	date
D.N.	D.F.	D.F.	08.02.2015
discipline	size	scale	
WATER	A3	N.T.S.	
drawing no	rev.		
RE14020/W/001/SR	1		