

THIS DRAWING IS SUBJECT TO COPYRIGHT AND MAY NOT BE REPRODUCED IN WHOLE OR PART OR IN ANY MANNER WHATSOEVER WITHOUT WRITTEN PERMISSION FROM CRONJE ASSOCIATED ARCHITECTS CC

Revision Schedule			
Rev	Date	Description	Issued to
1	15/12/2010	1-Layout for Welcome Centre revised	
2	14/01/2011	1-Layout of Welcome Centre rotated and revised	
3	25/01/2011	1-Covered walkway around building, 2-Luggage room moved position, 3-Wc for driver included at the back	
4	14/02/2011	1 - Welcome centre rotated and moved to eastern side of parking	
5	08/06/2011	1 - Structure and materials revised, 2 - Roof height reduced	
6	24/06/2011	1 - Entrance gum poles reduced to make columns more slender	

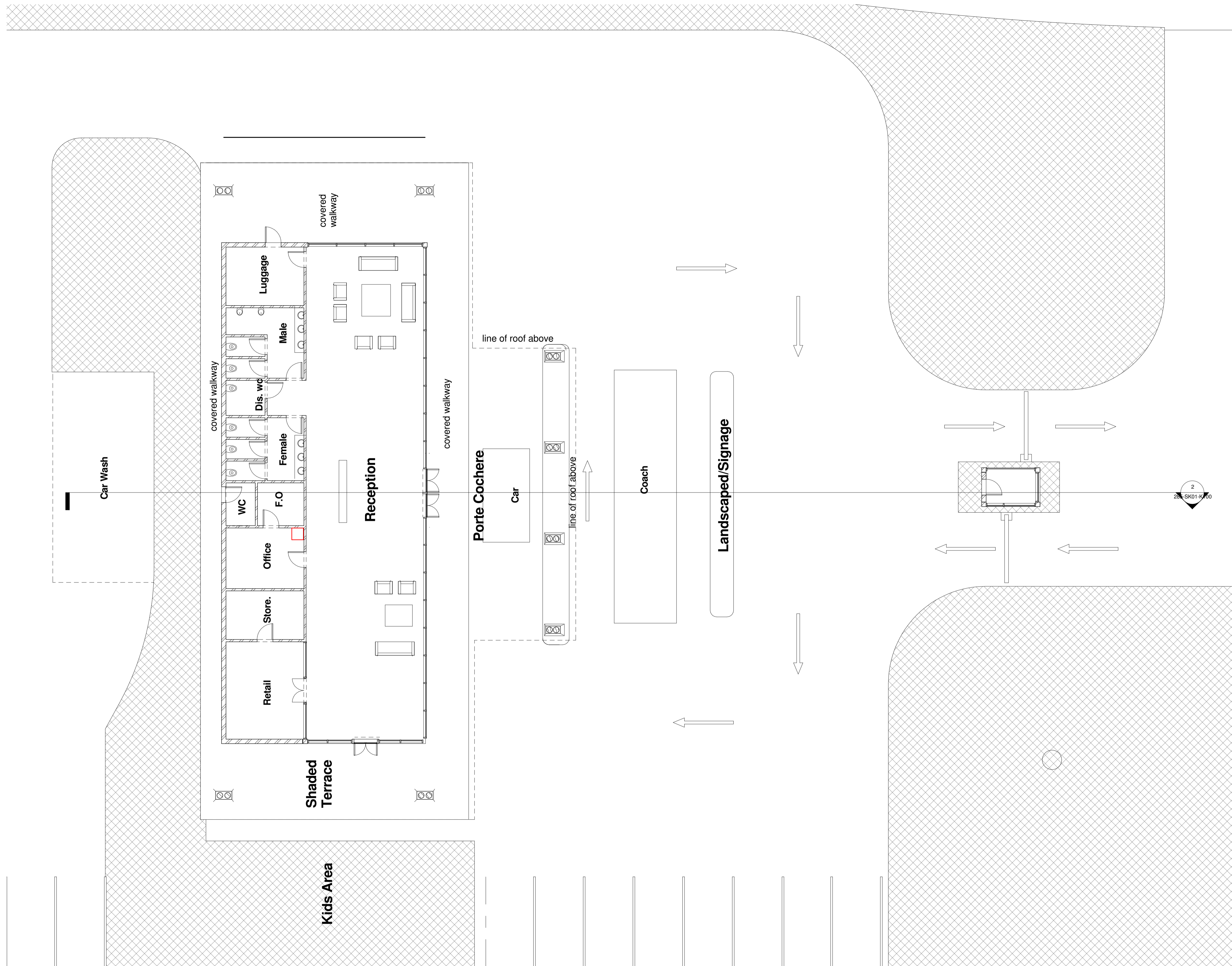

C:\Documents and Settings\Roger Kerr\Desktop\Curren\Jobs\1 - Week 27 July 4-82385 Radisson BluK welcome centre\2011\_06\_27 Welcome Centre.rvt

**1** Welcome Centre  
1 : 100

- ISSUE FOR COUNCIL SUBMISSION
- FOR INFORMATION ONLY      ○ ISSUE FOR APPROVAL
- FOR TENDER PURPOSES ONLY      ○ ISSUE FOR CONSTRUCTION

**SIGNED FOR CONSTRUCTION**

**ARCHITECT:** .....

**CLIENT:** .....

IF THIS DRAWING IS NOT SIGNED BY THE ARCHITECT IT IS NOT FOR CONSTRUCTION PURPOSES

**PROJECT**  
Radisson Blu- Safari Hotel- Kruger National Park

**ADDRESS**  
Enter address here

**DESCRIPTION**  
Welcome Centre Ground Floor Plan

**CRONJE ASSOCIATED ARCHITECTS CC**  
Suite E MGA HOUSE  
Wimble Close  
Ballito Business Park  
Po Box 6438 Zimbali 4418  
Tel: +27 32 946 3830/1  
Fax: +27 32 946 3835  
email: llewellyn@caarchitects.co.za  
reg no 2621



<b>Drawn</b> Sarah	<b>Project nr:</b> 285 <b>Sheet nr:</b> 285-SK01-K200	<b>Date:</b> 2011/07/05 02:11:38 PM
-----------------------	--	---